

# Commvault and Azure NetApp Files

Commvault Complete™ Backup & Recovery protects critical data and workloads running in the Azure NetApp Files service. This means your organization can migrate data and applications to the cloud that you previously thought too difficult. Commvault® software also allows you set common backup and disaster recovery policies for all of your cloud data, whether running on Azure NetApp Files, in Azure® or 3rd party clouds including AWS® and the Google Cloud Platform.™

## The benefits of Azure NetApp Files

A common challenge you're likely to face as you work to modernize applications and migrate them to the cloud is a lack of application-native file services. This prevents or makes it more difficult for you to migrate and modernize your file-based workloads – in most cases it means you have to re-architect or re-platform your enterprise applications to run in the cloud. A scary prospect whichever way you look at it.

The good news is that Microsoft and NetApp have addressed this challenge by introducing Azure NetApp Files. Azure NetApp Files is a fully managed cloud file services solution that means you can run your file-based enterprise applications in Azure without the need for code changes.

It's built on industry leading NetApp Data ONTAP technology and the Microsoft Azure cloud platform, providing extreme performance and low latency for file-based workloads running on Windows or LINUX. This makes it easier to move and deploy even the most demanding file-based applications to Azure, providing the performance that your business needs but without the need for an MBA to work out the commercials.

It's important to note that while Azure NetApp Files offers high performance, always-on encryption and point-in-time snapshots, you are still responsible for your own backup and data retention.

## Protection beyond snapshots for critical data

While snapshots are great for your short-term recovery needs, they typically don't provide for all types of recovery scenarios. Zone-to-zone recovery for example, or needs triggered by a disaster, corruption or human error. Some events might also need you to go back further than snapshots allow.

In addition to these recovery needs, highly regulated industries such as healthcare and finance need to retain data copies for longer, and risk officers will demand that data in the cloud must be as well protected as it is on premises. Even if industry regulations do not have a big impact on your organization, then it's likely that state, country or international laws mean you need to retain data copies beyond the life of a snapshot.

Commvault has been a long-time partner with both Microsoft and NetApp and is proud to collaborate with these two industry leaders to bring the most comprehensive backup and recovery solution for Azure NetApp Files.

## Enterprise class data protection for Azure NetApp Files

Commvault provides solutions to meet even the most demanding SLAs for critical workloads across your NetApp estate, and your wider data fabric. From FAS/AFF to NetApp HCI, NetApp Solidfire, NetApp StorageGRID and Cloud Volumes ONTAP.

These solutions not only protect your data, but also to safely and securely migrate, use and retain efficiently.

Commvault software supports protecting your Azure NetApp Files CIFS/NFS based file services to any location – across geos, back to your premises or to another cloud.

In addition to protecting your data, our software can also provide a comprehensive disaster recovery solution that protects the servers that process your critical file data.

The benefits of this solution:

- Multi-protocol support – Supports both CIFS & NFS file-based workloads in Microsoft Azure
- Improve recovery SLAs – Protect, replicate, dedupe or store your Azure NetApp File data on Azure Blob (hot/cool) Storage
- Simplified migration – eliminates the need for migration tools like robocopy or securecopy to move data to Azure NetApp Files
- Easy to deploy – Commvault software runs natively on Azure
- Lower operating costs – Commvault automatic power management in Azure helps to keep down your cloud billing

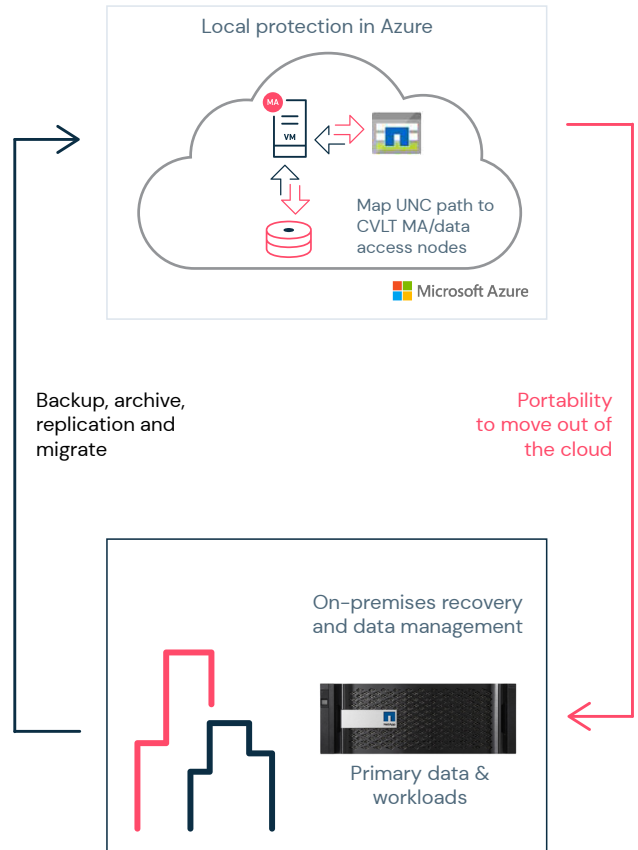

For more information on the Commvault and NetApp relationship visit our [NetApp](#) page and watch out for regular NetApp posts on the Commvault [blog](#) >